



## 2 Ridgeway Drive, Bellevue Heights

### One of a Kind - Architect designed by Jansen & Treloar Architects

Seemingly inspired by the famous 1940 Frank Lloyd Wright designed Bazett House in California, this timeless home is too ... a classic.

The position is superb. Enjoy living with a peaceful outlook to a natural environment, sea and sky-views and the night lights!

The location is brilliant. Flinders University is a nature walk away, Flinders Hospital and the exciting Tonsley Innovation Precinct are close by, while your choice of shopping which includes the Pasadena shopping complex, Westfield Marion and Blackwood Village are all just a short drive. You can be at Brighton beach in 12 minutes and the city in 20 minutes ... what a lucky place to live.

The 1258sqm corner allotment is site specific to the unique design of this fine home. Built for this wonderful position, the linear profile with its striking roof-line and twin-peaks is both discreet and spectacular at the same time, while two street frontages will make you look twice and intrigue the imagination.

The solid brick construction is impressive in the way stepped brickwork, clever changes in colour tone and quirky detailing frame each window to give this home its timeless appeal. The massive roof span and extended eaves have a two-tone terra-cotta tile that cleverly mirrors the linear design. Imagine re-creating all this today!

Driving past, you'd be forgiven for thinking there are two separate residences. For a start, there are two driveways ... but it is the brick and glass walk through entry foyer that connects both ends of the home and provides the perfect welcome to this very special place.

Inside, the accommodation is spacious and will appeal to growing families and couples too!

The split-level floor-plan flows effortlessly to create fantastic living spaces at one end of the home, while the cross floor-plan at the other end zones large bedrooms and bathrooms and provides a billiards/games room. Check-out the floor-plan!

Filled with natural light, the main living areas feel open plan but at the same time are zoned to create different living areas depending on the occasion. The lounge room features high timber ceilings, a library and built-in bar ... the formal dining area will accommodate the largest of tables ... there is an everyday dining area that

3 2 2

Land Area 1,258 sqm

**\$810,000 - \$890,000**

ID# 1772

**Open for Inspection**

By Appointment



Stephen Ring

8370 3211

0417 866 344

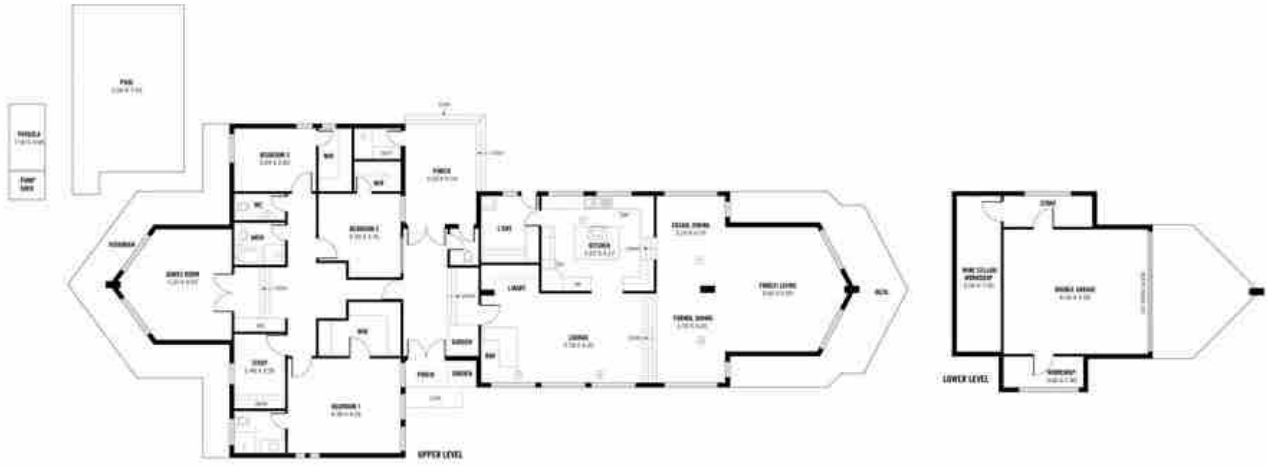

Water	22m <sup>2</sup>	People	10m <sup>2</sup>	Area	30m <sup>2</sup>
TOTAL	10m <sup>2</sup>	10m <sup>2</sup>	10m <sup>2</sup>	10m <sup>2</sup>	10m <sup>2</sup>

Scale in meters. The drawing is illustrative and not intended for construction purposes. All dimensions and areas are approximate and subject to change without notice.



Project by The Redwood Group